

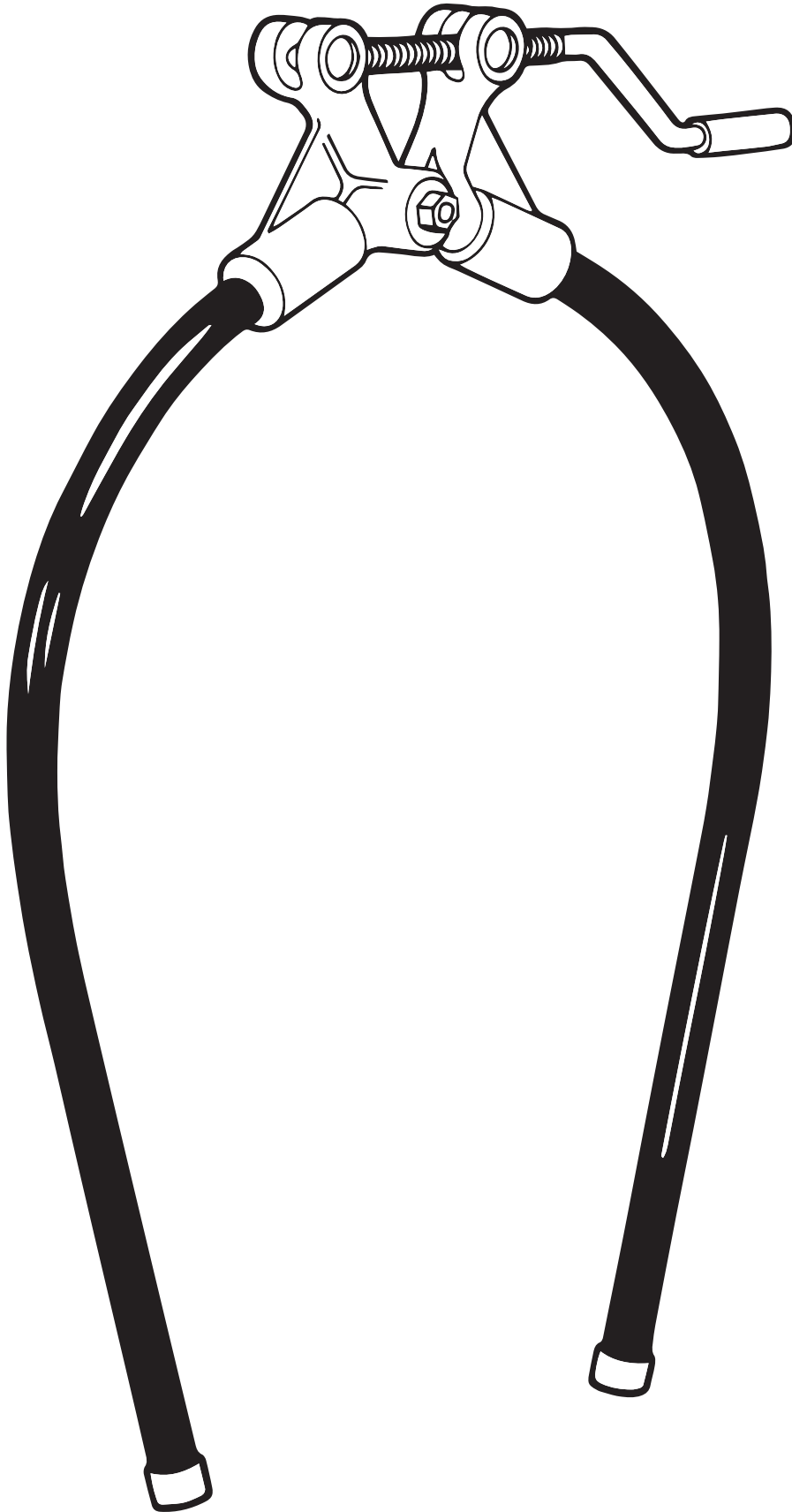

WESTERN
S A L E S

KOW KAN'T KICK™

Item No. 208



CLAMP DOWN ON WILD, UNRULY ANIMALS

Kow Kan't Kick is used and recommended by veterinarians, dairy and livestock producers around the world. The Kow Kan't Kick provides a safe, easy and humane way to help wild and unruly animals from kicking.

Kow Kan't Kick fits any size animal. It slips comfortably over the back depression muscles that control kicking. Rubber-tipped steel legs protect the animal against injury in tender areas. Precision machined parts allow for easy and quick operation from either side of the animal.

Kow Kan't Kick is the strong, humane and safe choice.

HOW TO USE

Make sure all parts are thoroughly oiled and greased at all times. If steel legs are too long, they may be sawed off to fit the animal. Place Kow Kan't Kick in front (not back) of hip bones letting the legs drape straight down in the hollow of the flank in front of the stifle joint. Turn the threaded handle until it's snug on the animal.



REPLACEMENT PARTS

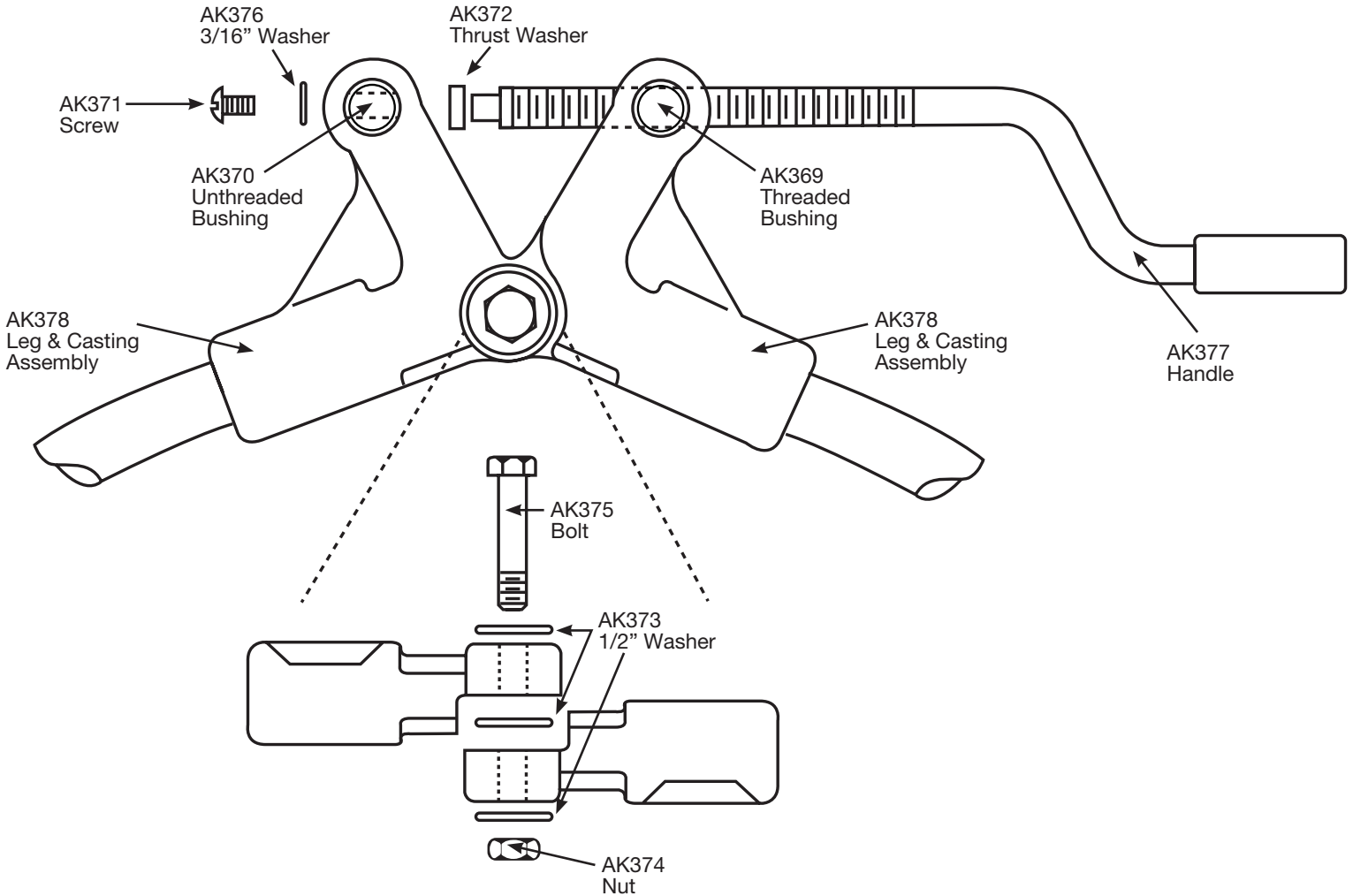

REPLACEMENT PARTS PACKAGES

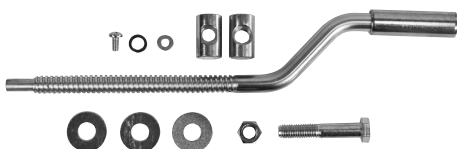

Complete Handle Assembly
AK389



Partial Handle Assembly
AK380